

SITE SECTION A-A  
Scale 1 : 500

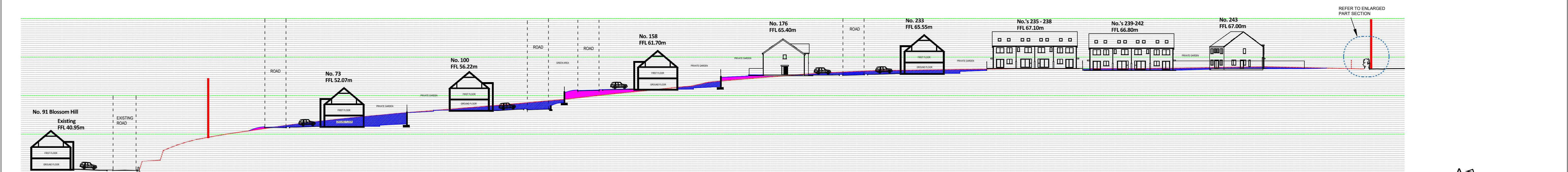

SITE SECTION B-B  
Scale 1 : 500

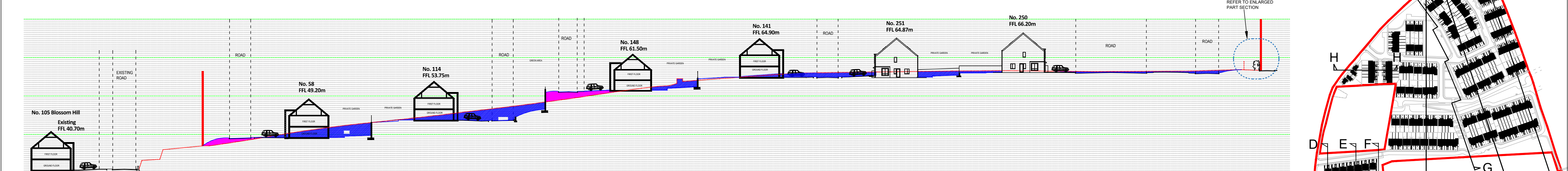

SITE SECTION C-C  
Scale 1 : 500

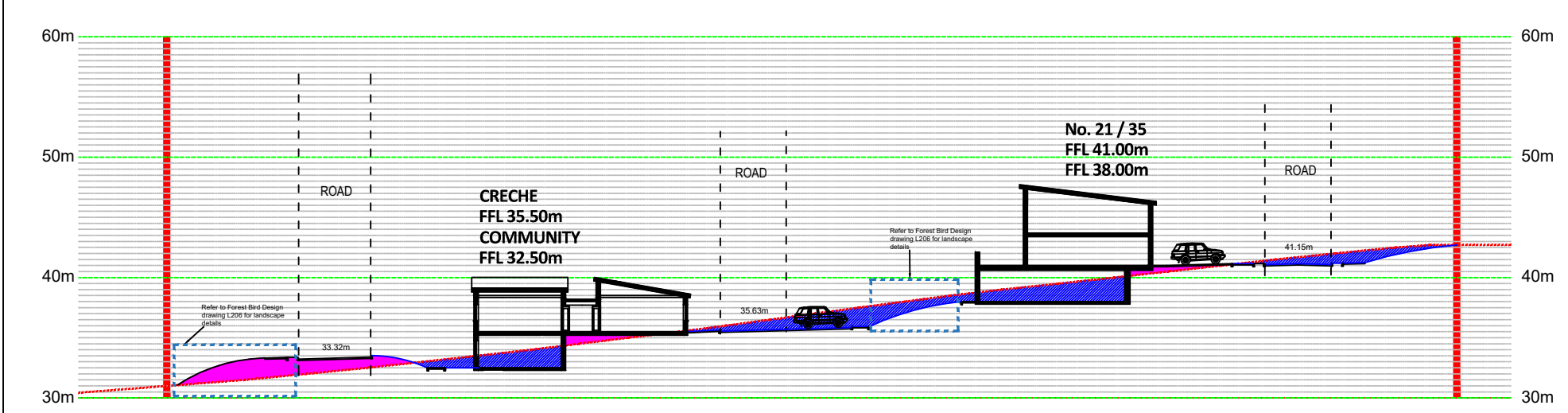
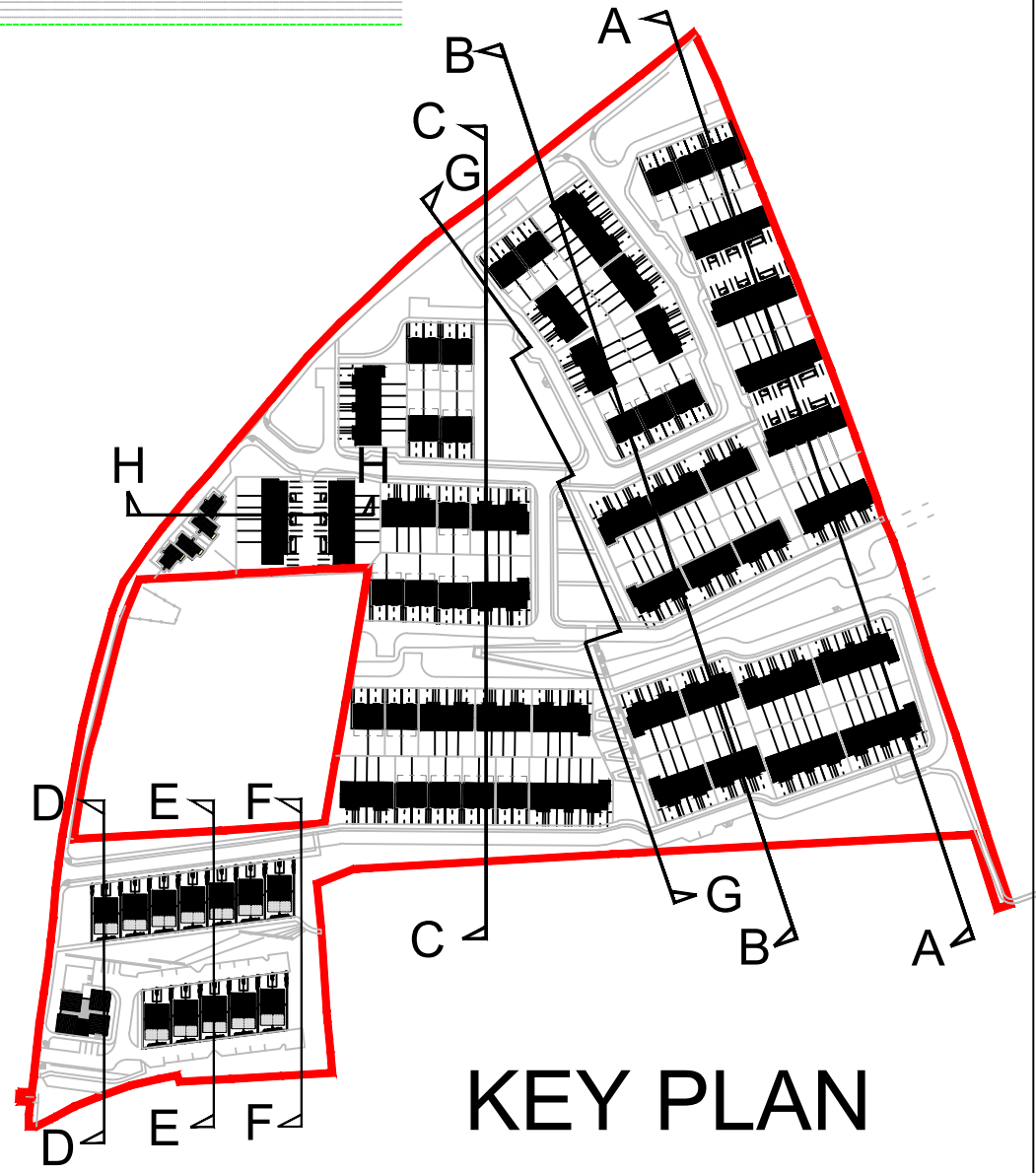

SITE SECTION D-D  
Scale 1 : 500

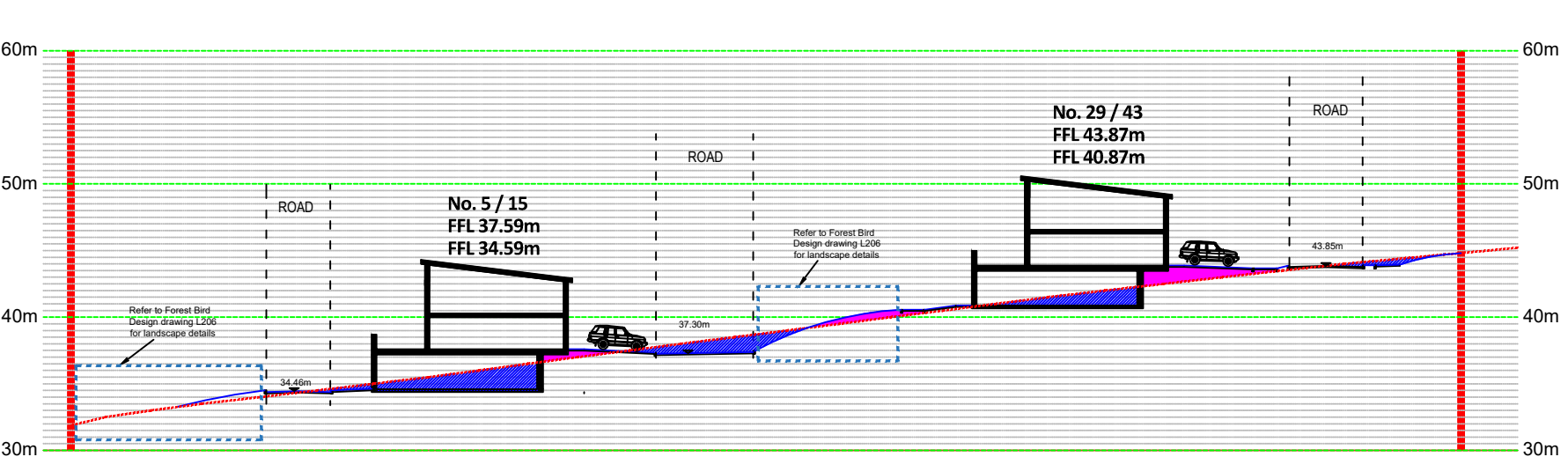

SITE SECTION E-E  
Scale 1 : 500

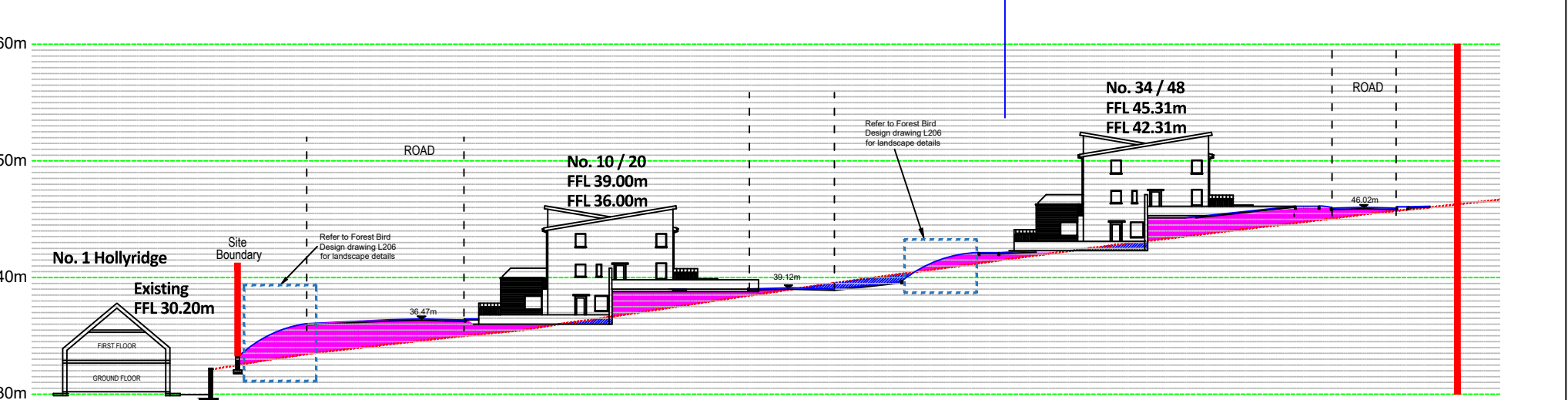

SITE SECTION F-F  
Scale 1 : 500

**Notes:**

- This drawing is for the purpose of the stage indicated only - If in doubt ask.
- Do not scale, figured dimensions only to be taken.
- Engineer/Architect to be informed of any discrepancies before work proceeds.
- Contractor to check all dimensions and conditions on site before commencing works.
- Drawing to be read in conjunction with current Building Regulations.
- All components and materials to be installed fully in accordance with manufacturers instructions.

SITE BOUNDARY

EXISTING GROUND LEVEL

PROPOSED LEVELS

PROPOSED FILL

PROPOSED EXCAVATION

REFER TO ENLARGED SECTIONS  
DRAWINGS 22/6372-P-1201 TO P-1219  
AT SCALE 1:100

REFER TO DRAWING 22/6372-P-1110  
FOR RETAINING WALL DETAILS

REFER TO DRAWING 22/6372-P-1211  
FOR ESTATE ROAD DETAILS

Rev	Date	Description	Drawn	Chk'd
A	09-10-2023	ISSUED FOR PLANNING APPLICATION	JB	BOK/GF
B	27-02-2024	ISSUED FOR FURTHER INFORMATION	G.F.	BOK

**BRIAN O KENNEDY & ASSOCIATES LTD**  
Engineers & Architects

Shannon House,  
Church Road,  
Douglas,  
Co. Cork

Tel: 021-4999854  
Fax: 021-4999854  
Email: info@bok.ie  
Web: www.bok.ie

ENGINEERING | ARCHITECTURE | ASSIGNED CERTIFIERS  
FIRE CERTIFICATES | DAC | PROSP | CONSERVATION

GENERAL NOTE:  
This drawing is the property of Brian O'Kennedy & Associates.  
Copyright is reserved. The drawing shall not be copied, reproduced or  
otherwise used without the consent of Brian O'Kennedy & Associates.

Drawing Status:  
**LRD PLANNING APPLICATION**

Client: CASTLE ROCK HOMES MIDLETON LTD.

Project: RESIDENTIAL DEVELOPMENT - BROOMFIELD MIDLETON

Drawing: PROPOSED SITE SECTIONS OVERVIEW

Drawing number:  
**22/6372-P-1200**

Scale: 1:500 @ A1

Rev:  
**B**

Drawn/Chk'd:  
JB GF