

SITE SECTION G-G
Scale 1 : 500

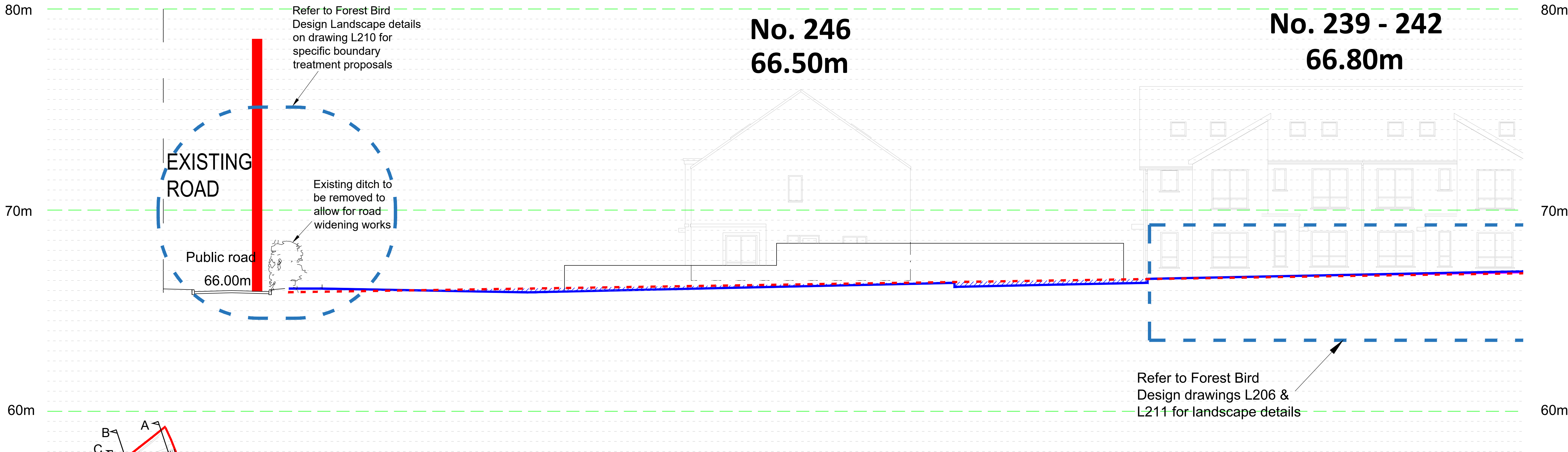

SITE SECTION G-G (part 1)

Scale 1 : 100

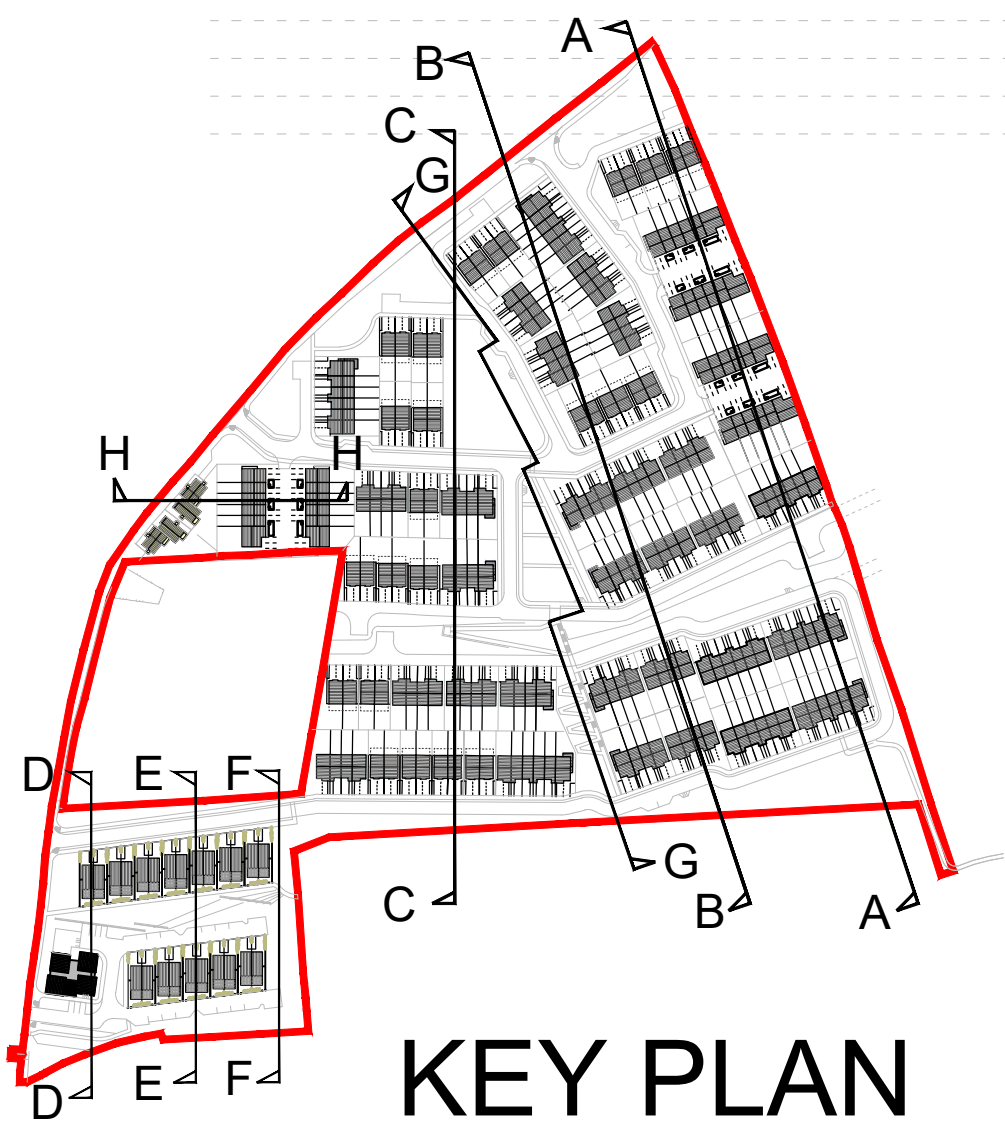

KEY PLAN

Notes:

1. This drawing is for the purpose of the stage indicated only. - If in doubt ask.
2. Do not scale, figured dimensions only to be taken.
3. Engineer/Architect to be informed of any discrepancies before work proceeds.
4. Contractor to check all dimensions and conditions on site before commencing works.
5. Drawing to be read in conjunction with current Building Regulations.
6. All components and materials to be installed fully in accordance with manufacturers instructions.

- SITE BOUNDARY
- EXISTING GROUND LEVEL
- PROPOSED LEVELS

- PROPOSED FILL
- PROPOSED EXCAVATION

REFER TO DRAWING 22/6372-P-1110
FOR RETAINING WALL DETAILS

Rev	Date	Description	Drawn	Chk'd
A	09-10-2023	ISSUED FOR PLANNING APPLICATION	JB	BOK/GF
B	27-02-2024	ISSUED FOR FURTHER INFORMATION	G.F.	BOK

BRIAN O KENNEDY & ASSOCIATES LTD
ENGINEERS • ARCHITECTS

Shannon House,
Church Road,
Douglas,
Co. Cork

Tel: 021-4899854
Fax: 021-4899854
Email: info@bok.ie
Web: www.bok.ie

ENGINEERING | ARCHITECTURE | ASSIGNED CERTIFIERS
FIRE CERTIFICATES | DMC | PROSP | CONSERVATION

GENERAL NOTE:
This drawing is the property of Brian O'Kennedy & Associates.
Copyright is reserved. The drawing shall not be copied, reproduced or
otherwise used without the consent of Brian O'Kennedy & Associates.

ENGINEERS
IRELAND

Drawing Status:
LRD PLANNING APPLICATION

Client: CASTLE ROCK HOMES MIDLETON LTD.

Project: RESIDENTIAL DEVELOPMENT - BROOMFIELD MIDLETON

Drawing: PROPOSED SITE SECTION G-G
(PART 1)

Drawing number:
22/6372-P-1220

Rev: **B**
JB GF

Date: 03-01-2023
Scale: 1:100 @ A1